



Cabinet Base Work Tables

Stainless Steel Cabinet Base Tables

Certifications:



Features:

- 1 5/8" x 6" Straight S/S Leg
- Legs Adjust 1" in Height
- Extra Supporting "C" Channel for top & bottom shelf consists of 2 Channels running left to right and 1 channel running front to back
- Casters Available

Material:

- T-304 14 ga. Stainless Steel Top
- T-304 18 ga. Stainless Steel Body
- Stainless Steel Legs & Feet



Length	24" Width WITHOUT Sliding Doors	30" Width WITHOUT Sliding Doors
24"	BKDC-2424	-
30"	-	BKDC-3030
36"	BKDC-2436	BKDC-3036
48"	BKDC-2448	BKDC-3048
60"	BKDC-2460	BKDC-3060
72"	BKDC-2472	BKDC-3072
96"	-	BKDC-3096

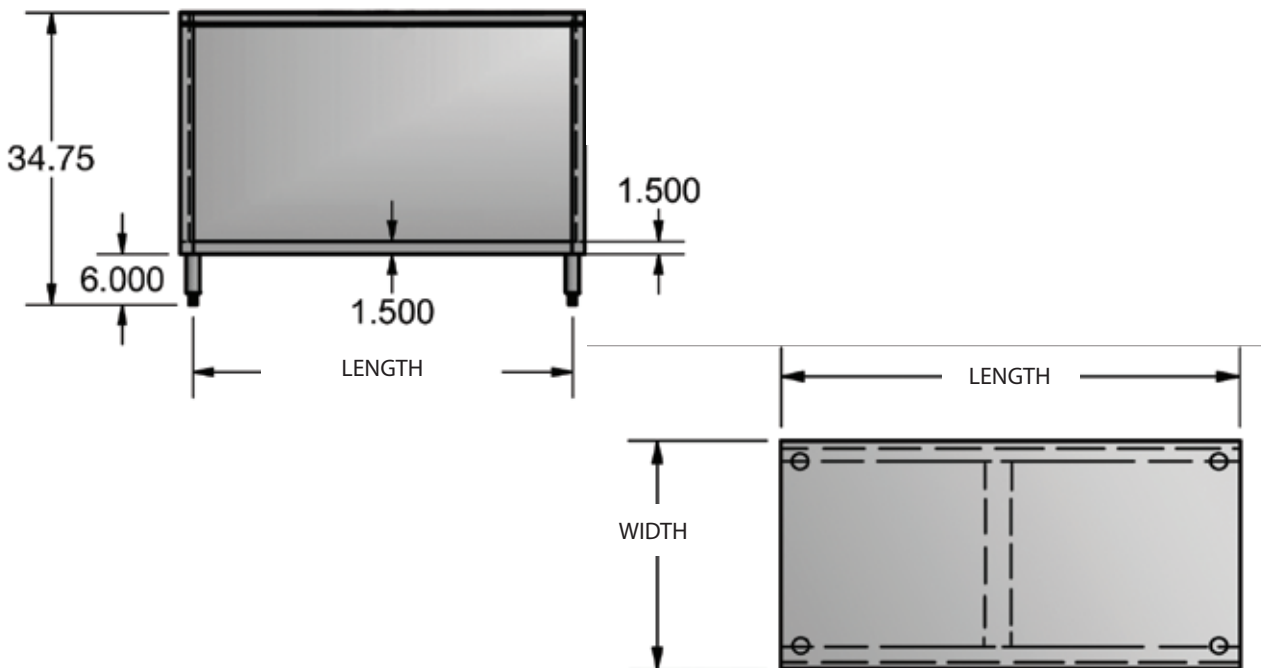

PRODUCT DATA SHEET